

### 1. Adjust and install latch

Measure your door backset as shown.

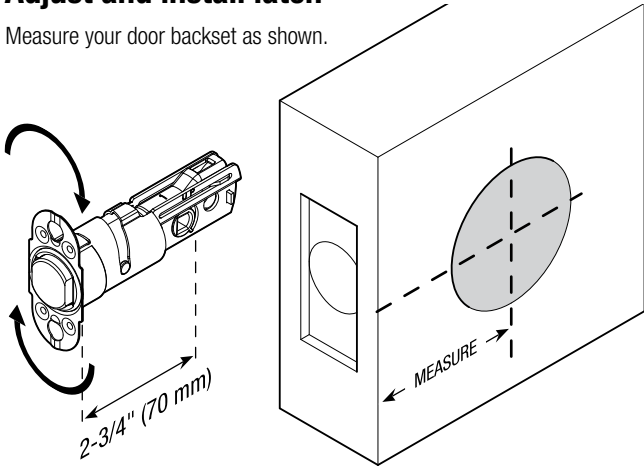

⚠ If backset of door measures 2 3/4" (70mm), adjust latch by rotating face as shown.

### LATCH FACE ASSEMBLY

#### For Drive-In Latch

Remove backplate.

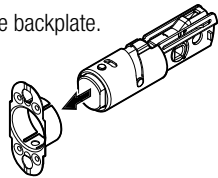

Snap on collar.

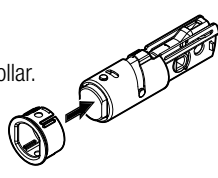

### LATCH INSTALLATION

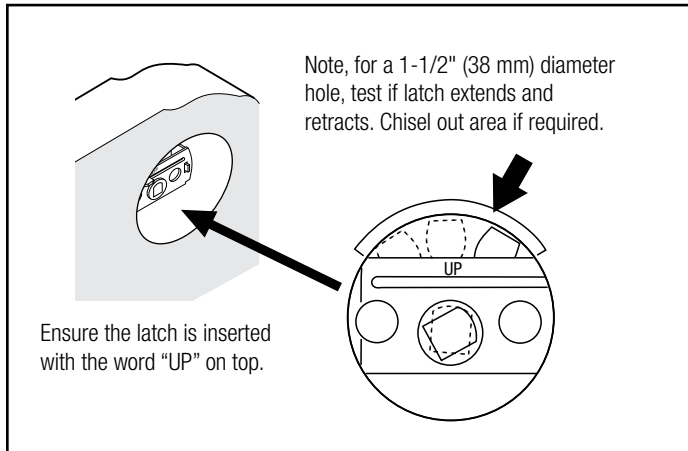

#### For Square Corner/ Round Corner

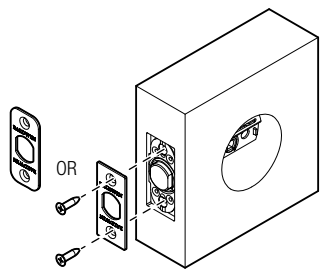

Install with 1/2" (13 mm) screws.

#### For Drive-In Latch

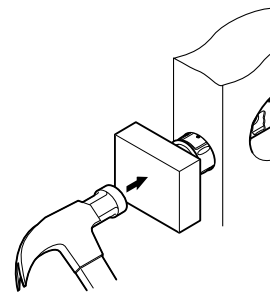

Drive in with hammer.

⚠ **WARNING:** This Manufacturer advises that no lock can provide complete security by itself. This lock may be defeated by forcible or technical means, or evaded by entry elsewhere on the property. No lock can substitute for caution, awareness of your environment, and common sense. Builder's hardware is available in multiple performance grades to suit the application. In order to enhance security and reduce risk, you should consult a qualified locksmith or other security professional.

### 2. Install Trim

Please note: Product illustrations may differ from your product. Installation is the same.

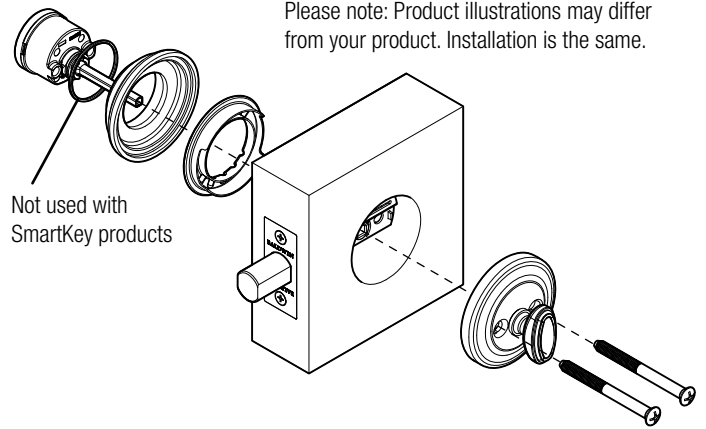

### 3. Install Strike

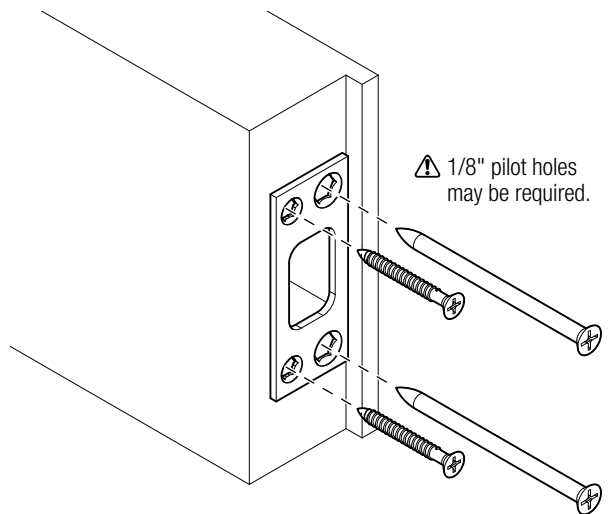

### THICK DOOR KIT INSTALLATION INSTRUCTIONS (AVAILABLE SEPARATELY)

Supports 2" (51 mm) up to 2-1/2" (64 mm) doors

After the completion of Step 1, install the longer torque blade supplied in the kit. Proceed to Step 2 and install with longer screws.

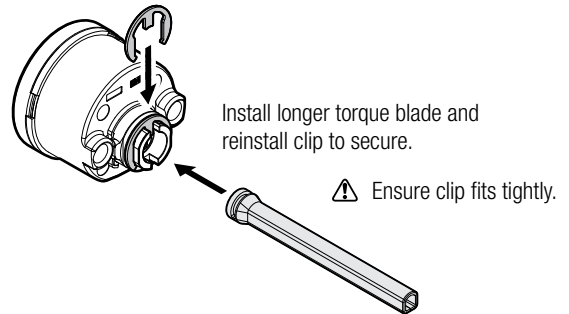
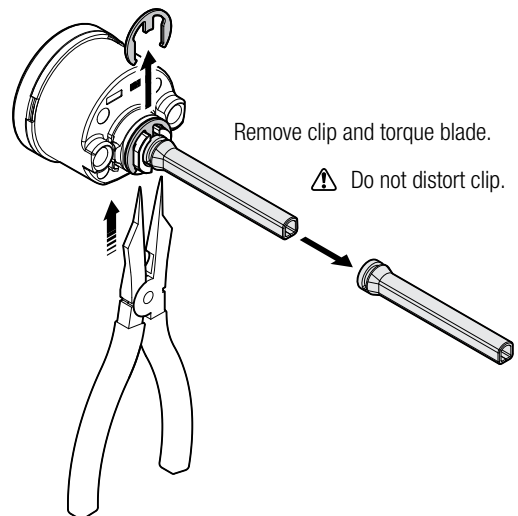

### Door Preparation

If your door requires drilling, use the supplied template below with the door preparation instructions available at www.baldwinhardware.com

#### TEMPLATE

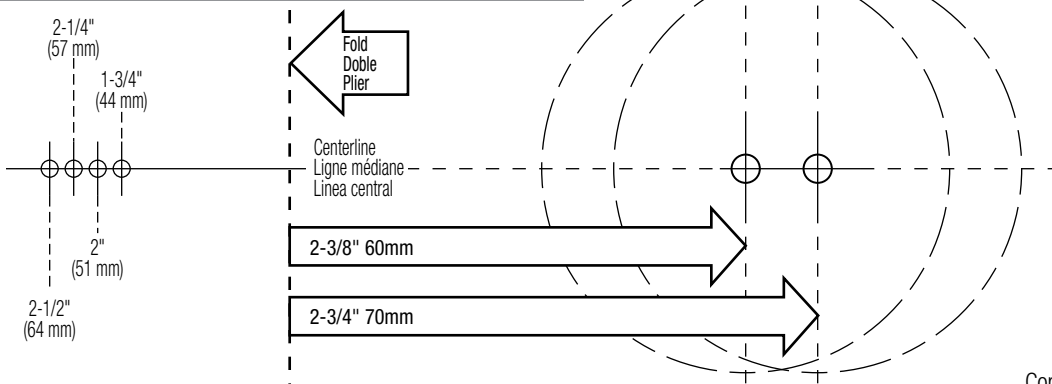

The drilling template must be printed to scale to ensure correct hole placement. To confirm correct print scale, the square below must measure exactly 1" by 1" (25mm x 25mm).

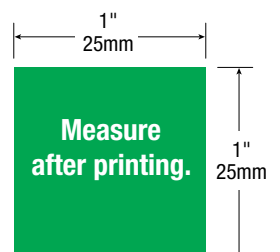

47039 / 01